

Model: 438-CD

Extruded Aluminum Louver
Combination Drainable/Adjustable Blades

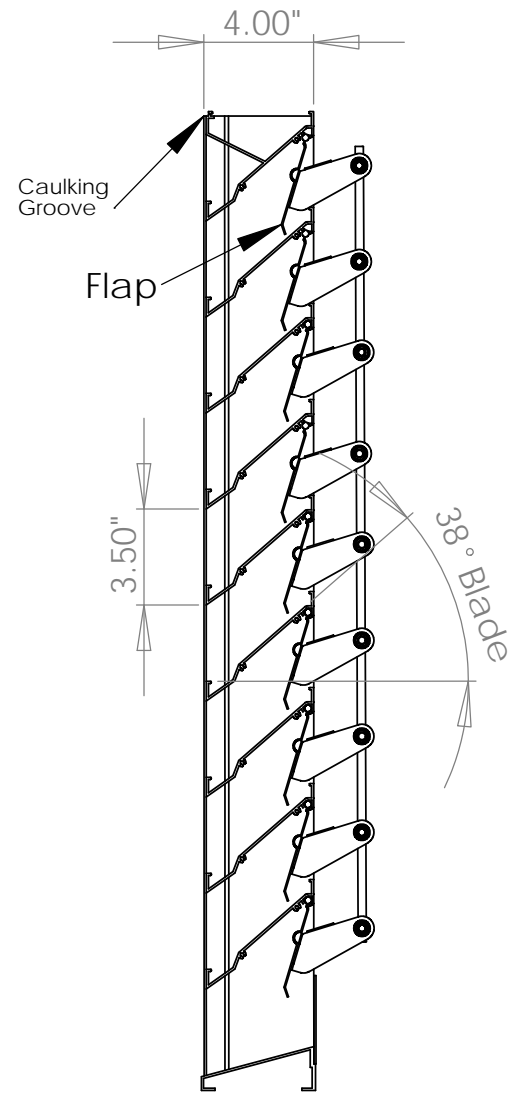
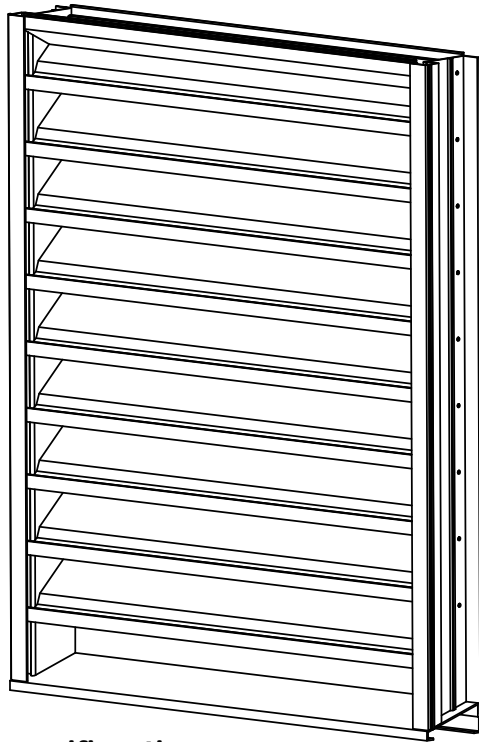

Standard Specifications:

Frame: 6063-T5 Alloy .081" thick extruded aluminum.

Blade: Drainable design .08" thick 6063-T5 extruded aluminum, mechanically fastened, set on 38 degree angles. Blades are 3.5" apart. (Bottom blade opening varies).

Birdscreen: 1/2" - 19ga. galvanized birdscreen standard

Minimum size:
8.38" height

Maximum Size:
72"w x 96"h Single Section.

Sill Type A

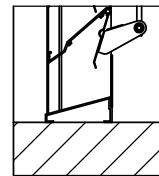

Sill Type B

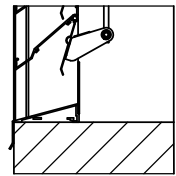

Options:

- Expanded Aluminum Birdscreen
- Removable Birdscreen
- Removable Insect Screen
- 1 1/2" Flange Frame
- Adjustable Sill Extension
- Kynar Finish
- Anodized Finish
- Powder Coating (Other Finishes Available)

57% Free Area

Note: All 438-CD louvers are built 1/4" under size both directions unless ordered actual size.

LEADER
Dampers & Louvers

P.O. Box 40913
Nashville, TN 37204
www.leaderindustries.com
A Division of Leader Industries, Inc.

Model 438-CD Extruded Aluminum Louver

Combination Drainable/Adjustable Blades

CFM and FREE AREA Chart WIDTH (in)

		12	18	24	30	36	42	48	54	60	66	72
HEIGHT (in)	12	262 .29	418 .47	574 .64	730 .81	886 .99	1043 1.16	1199 1.34	1355 1.51	1511 1.68	1667 1.86	1823 2.03
	18	454 .51	725 .81	996 1.11	1267 1.41	1538 1.71	1809 2.02	2080 2.32	2351 2.62	2622 2.92	2893 3.23	3164 3.53
	24	647 .72	1033 1.15	1418 1.58	1804 2.01	2190 2.44	2576 2.87	2961 3.30	3347 3.73	3733 4.16	4118 4.59	4504 5.02
	30	922 1.03	1472 1.64	2022 2.25	2572 2.87	3122 3.48	3672 4.09	4222 4.71	4772 5.32	5322 5.93	5872 6.55	6422 7.16
	36	1126 1.26	1798 2.00	2470 2.75	3142 3.50	3814 4.25	4486 5.00	5158 5.75	5829 6.5	6501 7.25	7173 8.00	7845 8.75
	42	1316 1.47	2101 2.34	2885 3.22	3670 4.09	4455 4.97	5240 5.84	6025 6.72	6809 7.59	7594 8.47	8379 9.34	9164 10.22
	48	1560 1.74	2491 2.78	3421 3.81	4352 4.85	5282 5.89	6213 6.93	7143 7.96	8074 9.00	9004 10.04	9935 11.08	10865 12.11
	54	1793 2.00	2862 3.19	3931 4.38	5000 5.57	6069 6.77	7138 7.96	8207 9.15	9276 10.34	10345 11.53	11415 12.73	12484 13.92
	60	1985 2.21	3169 3.53	4353 4.85	5537 6.17	6721 7.49	7904 8.81	9088 10.13	10272 11.45	11456 12.77	12640 14.09	13824 15.41
	66	2177 2.43	3476 3.88	4775 5.32	6073 6.77	7372 8.22	8671 9.67	9969 11.11	11268 12.56	12567 14.01	13865 15.46	15164 16.91
	72	2453 2.73	3916 4.37	5380 6.00	6843 7.63	8306 9.26	9769 10.89	11232 12.52	12695 14.15	14158 15.78	15622 17.42	17085 19.05
	78	2654 2.96	4237 4.72	5820 6.49	7403 8.25	8986 10.02	10569 11.78	12152 13.55	13735 15.31	15318 17.08	16901 18.84	18484 20.61
	84	2847 3.17	4544 5.07	6242 6.96	7940 8.85	9638 10.74	11335 12.64	13033 14.53	14731 16.42	16429 18.32	18126 20.21	19824 22.10
	96	3323 3.70	5305 5.91	7287 8.12	9269 10.33	11252 12.54	13234 14.75	15216 16.96	17198 19.17	19180 21.38	21162 23.59	23144 25.80

This table has been developed to assist in application and selection of these louvers. Two numbers are shown for each louver size. The upper number chows CFM of air flow permitted when selecting an intake louver at the point of zero water penetration. Pressure drop when using this Selection Guide for an intake louver will be .13 in. wg. The lower number shows sq. ft. of louver free area for each louver size. Louvers may be selected at other operating points on the Performance Curves if desired using the formula. CFM=Free Area (sq.ft.) X Free Area Velocity (fpm)

The ratings shown are based on test and procedures performed in accordance with AMCA Publication 511.

Water Penetration Chart

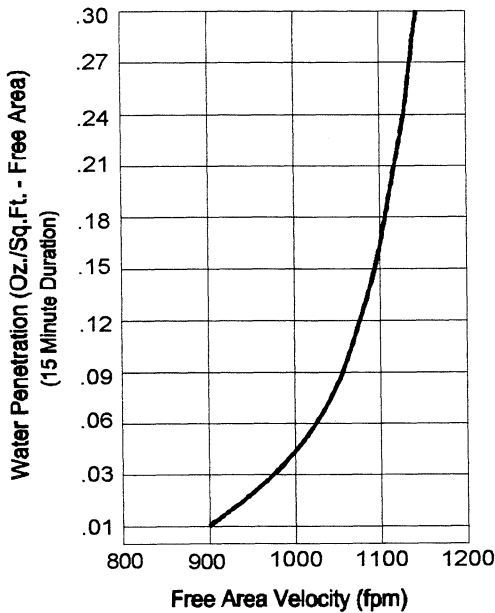

The performance data applies to air capacities in intake mode only. Performance shown is at standard air density .075 lbs/ft³.

Water Penetration Data applies to test unit size 48" x 48" only. Beginning of Water Penetration is 897 fpm Free Area Velocity.

Air Performance Chart

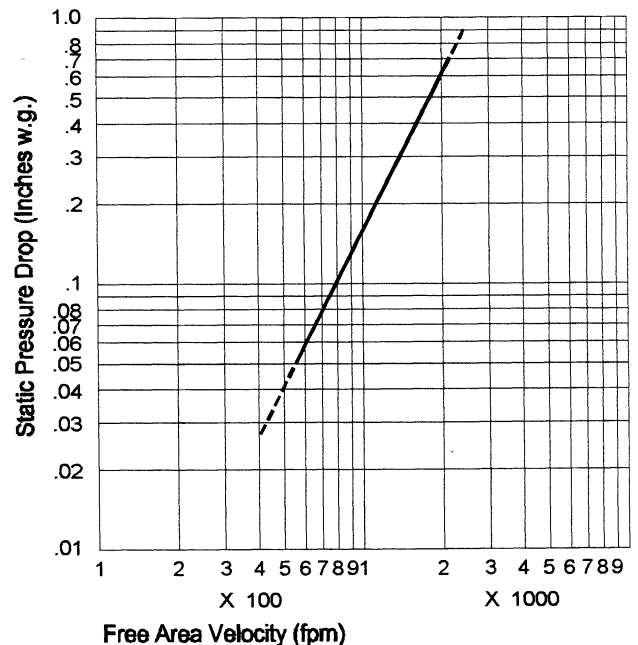

Ratings do not include the effects of birdscreen.



A Division of Leader Industries, Inc.

P.O. Box 40913
Nashville, TN 37204
www.leaderindustries.com

438-CD November 2000